

Roll-in 1 Glass Door Refrigerator, 750lt (+2/+10)

ITEM # _____

MODEL # _____

NAME # _____

SIS # _____

AIA # _____



729173 (ARI075R1G)

1-glass door roll-in refrigerator
750L, +2+10°C, (R134A), AISI
304

Short Form Specification

Item No. _____

External and internal in AISI 304 stainless steel. Insulation thickness 60mm. Right hinged glass door with lock. Bottom door gasket adjustable. Built-in refrigeration unit; ventilated operating mode; digital control; evaporator; automatic defrost; external digital temperature display; high/low humidity switch; internal lighting. Operating temperature +2+10°C. For ambient temperatures up to 32°C. CFC and HCFC free. R134a gas in refrigeration circuit. Gas in foam: Cyclopentane.

Main Features

- Certified safety CE requirements.
- Excellent space optimisation thanks to the compact dimensions (footprint 0.56m²).
- Adjustable temperature range from -2 °C to +10 °C to suit meat, fish and dairy storage requirements.
- Right hinged glass door.
- The operating temperature can be adjusted from +2 to +10°C to suit both meat and dairy storage requirements.
- Performance guaranteed at ambient temperatures of +32°C.
- Large digital white-digit display with humidity selection button (3 preset level), internal temperature display and setting, manual activation of defrost cycle and turbo frost cycle (to rapidly cool warm loads).
- Simple control panel: on/off switch, high/low humidity switch and digital temperature display.
- Equipped with Optiflow forced air circulation system for rapid cooling and temperature distribution within the cell.
- Automatic defrost and automatic evaporation of defrost water.
- Tropicalized unit (43°C ambient temperature).
- Ventilated cooling for optimal temperature distribution.
- Fitted with 90 mm thickness of cyclopentane insulation for best insulating performance (thermal conductivity: 0,020 W/m*K) and lowest environmental impact (GWP=3).
- Simple cooling unit easily accessible from the rear of the appliance.
- 0mm clearance installation space: tower configuration cooling unit guarantee performance with frontal ventilation only; this unique solution allows installation against the wall or side by side with other appliances, even on the cooling unit side to maximize the use of kitchen space.
- Inner side protectors to protect the internal walls.
- Suitable for all kinds of 18 shelves GN 1/1 trolleys, designed to fit the 18 shelves GN 2/1 trolley available as optional accessory.
- Frost Watch Control starts automatically the defrosting process only when needed and ends once ice is melted, improving energy efficiency results.
- Adjustable bottom door gasket.
- Combination of doors and drawers to suit any configuration needed, with the possibility to change the configuration on site. Right cooling unit available on request.
- Lift-up control panel to better access main components.
- Fully compliant HACCP digital control: when temperature exceeds critical limits, acoustic and visual alarms are activated. Up to two months of event are kept in memory.

APPROVAL: _____

- Anti-tilt runners accept GN 1/1 containers.
- Self closing stainless steel doors (< 90°).
- Prearranged to fit RS485 port to facilitate connection to a remote computer and integrated HACCP systems.
- Hydrocarbon refrigerant gas R290 for the lowest environmental impact (GWP=3) - CFC and HCFC free.
- CFC and HCFC free, highly ecological refrigerant type: R290 (ecological gas in foam: cyclopentane). Hydrocarbon refrigerant gas R290 for the lowest environmental impact (GWP=3), to reduce green house and ozone depletion effects.
- Connectivity ready for real time access to connected appliances from remote and data monitoring (requires optional accessory).

Construction

- Built-in compressor to suit operating conditions.
- Interior cell and external panel are constructed in 304 AISI stainless steel.
- Bottom panel with rounded internal corners avoids dirt traps.
- Refrigerant type: R134a.
- Developed and produced in ISO 9001 and ISO 14001 certified factory.
- Cabinet fitted with up to 60 mm thickness of Cyclopentane insulation for best insulating performance (thermal conductivity: 0,020 W/m*K). CFC and HCFC-free insulation.
- Interior base with rounded corners, pressed from a single sheet.
- Ease of cleaning and high hygiene standards thanks to the rounded internal corners, the easily removable runners, grids and air conveyors.
- Internal structure with 15 charging positions (3 cm pitch) available to host GN 1/1 grids, ensuring higher net capacity and a greater storage space.
- Removable triple-chamber balloon magnetic gasket to improve insulation and reduce energy consumption and ease of cleaning.
- Internal structure with numerous charging positions available to host grids, ensuring higher net capacity and a greater storage space.
- Internal and external doors, front and side panels and removable worktop in AISI 304 Stainless steel.
- External bottom panel in stainless steel.
- External back panel in galvanized steel.
- Fault code display.

Optional Accessories

- Trolley for 18x2/1GN roll-in 750L PNC 881521



Front

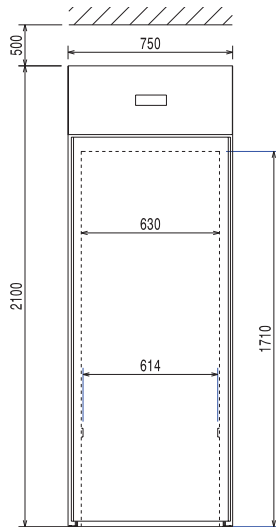

Side

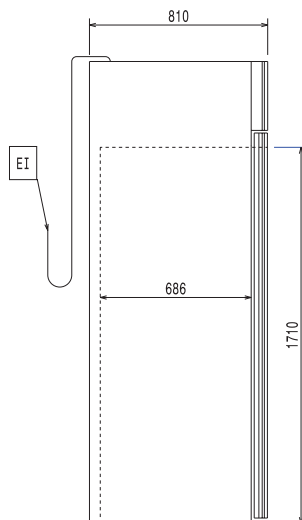

EI = Electrical inlet (power)

Top

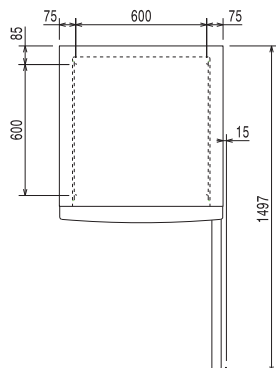

Electric

Supply voltage:	729173 (ARI075R1G)	230 V/1 ph/50 Hz
Electrical power max.:		0.7 kW
Defrost Power:		0.45 kW
Current consumption:		3.3 Amps
Plug type:		CE-SCHUKO
Energy consumption (min,default):		0 - 6.19 kW/h

Key Information:

Gross capacity:	750 lt
Net Volume:	615 lt
Door hinges:	Right Side
External dimensions, Width:	750 mm
External dimensions, Depth:	810 mm
External dimensions, Height:	2100 mm
Number and type of doors:	1 Glass
Internal Dimensions, Width:	614 mm
Internal Dimensions, Depth:	673 mm
Internal Dimensions, Height:	1675 mm
Net weight:	150 kg
Shipping volume:	1.55 m ³
Height adjustment:	0/0 mm
Number and type of grids (included):	- GN 2/1

Refrigeration Data

Control type:	Digital
Compressor power:	3/8 hp
Refrigerant type:	R134a
GWP Index:	1430
Refrigeration power:	645 W
Refrigeration power at evaporation temperature:	-10 °C
Refrigerant weight:	260 g
Min/Max internal humidity:	70/80
Operating temperature min.:	2 °C
Operating temperature max.:	10 °C
Operating mode:	Ventilated

Product Information (EU Regulation 2015/1094)

Energy Class:	
Yearly and daily energy consumption:	
Climate class:	
Energy Efficiency Index (EEI):	

Roll-in
1 Glass Door Refrigerator, 750lt (+2/+10)

The company reserves the right to make modifications to the products without prior notice. All information correct at time of printing.

2022.07.28